



# H T K

P A Y S T A T I O N

## INSTALLATION MANUAL

Car Wash Application

**Hamilton Manufacturing Corp.**

P: 419.867.4852 | P: 888.723.4858 | F: 419.867.4850

[www.hamiltonmfg.com](http://www.hamiltonmfg.com)



To view the **HTK Programming Manual**, visit [www.hamiltonmfg.com/documentation](http://www.hamiltonmfg.com/documentation) or scan the QR code below to download to your device:



The contents of this manual do not purport to cover all details or variations in the HTK Pay Station, and does not claim to provide for every possible contingency met in connection with installation or maintenance. All information is subject to change without notice.

© 2020 Hamilton Manufacturing Corporation

# Table of Contents

---

## Introduction

About This Manual .....	5
Warranty Card .....	5
Dedicated Power Source .....	5

## Mechanical Installation

Receiving and Unpacking HTK .....	6
Positioning .....	7
Mounting .....	7
Running Conduit .....	7
Dimensions: Brick-In Cabinet .....	8
Brick-In Bolt Pattern .....	11
Dimensions: Free-Standing Cabinet .....	12
Free-Standing Bolt Pattern .....	14
Lane Layout (when using gates) .....	15

## Electrical Installation

Pulling Wires .....	17
Wire Terminations .....	18
Electrical Diagrams .....	20
Car Wash Cycle Synchronization: Active or Passive .....	24

## Component Connections

Power Supply .....	25
Controller .....	26
Distribution Board .....	29
Smart Bus Hub .....	30
Bill Dispenser .....	31
Stacker Interface .....	32

## Gate & Loop References

References .....	33
------------------	----

## Warranty

Limited Warranty Agreement .....	34
----------------------------------	----

# List of Figures

---

## UNPACKING

Figure 1.1: HTK pallet (face) .....	6
Figure 1.2: HTK pallet (side) .....	6

## DIMENSIONS - BRICK-IN

Figure 2.1: Top of cabinet .....	8
Figure 2.2: Base of cabinet .....	8
Figure 2.3: Side of cabinet .....	9
Figure 2.4: Rear of cabinet .....	9
Figure 2.5: Door .....	10

## BRICK-IN BOLT PATTERN

Figure 3.1: Brick-in HTK bolt pattern .....	11
---	----

## DIMENSIONS - FREE-STANDING

Figure 4.1: Top of cabinet .....	12
Figure 4.2: Base of cabinet .....	12
Figure 4.3: Sides of cabinet .....	13
Figure 4.4: Rear of cabinet .....	13
Figure 4.5: Door & base of HTK .....	13

## FREE-STANDING BOLT PATTERN

Figure 5.1: Free-standing HTK bolt pattern .....	14
--	----

## LANE LAYOUT

Figure 6.1: Front view of brick-in lane layout .....	15
Figure 6.2: Front view of free-standing lane layout .....	15
Figure 6.3: Overhead view of lane layout .....	16
Figure 6.4: Service door orientation .....	16

## ELECTRICAL DIAGRAMS

Figure 7.1: Power supply wiring connection .....	20
Figure 7.2: Wash Interface diagram .....	21
Figure 7.3: Wash Interface diagram, angled .....	21
Figure 7.4: Gated Sequence Software Ether Vend (MIB Gate) .....	22
Figure 7.5: Gated Sequence Software Ether Vend (Micro Drive Gate) .....	23
Figure 7.6: Passive Cycles .....	22
Figure 7.7: Active Cycles .....	22

## COMPONENT CONNECTIONS

Figure 8.1: Power supply connections .....	25
Figure 8.2: Gen 5 controller connections .....	26
Figure 8.3: Gen 4 controller connections .....	27
Figure 8.4: Gen 3 controller connections .....	28
Figure 8.5: Distribution board connections .....	29
Figure 8.6: Smart Bus Hub connections .....	30
Figure 8.7: Bill dispenser connections .....	31
Figure 8.8: Stacker interface connections .....	32

# Introduction

---

## PLEASE READ THIS MANUAL IN ITS ENTIRETY PRIOR TO INSTALLATION.

A minimum of two (2) people should be present for installation to minimize risk of injury due to the weight and size of HTK. *Hamilton is not responsible for any injury caused due to improper installation.*

### About This Manual

This manual was written to provide general information and guidance for the installation of an HTK pay station. If you require additional assistance from the manufacturer, you may call **(419) 867-4852**, or email [customerservice@hamiltonmfg.com](mailto:customerservice@hamiltonmfg.com).

When requesting assistance, ensure you have serial numbers readily available. We recommend recording these numbers in the spaces below for easy future reference:

HTK MODEL & SERIAL # \_\_\_\_\_

CONTROLLER MODEL & SERIAL # \_\_\_\_\_

HOPPER 1 MODEL & SERIAL # \_\_\_\_\_

HOPPER 2 MODEL & SERIAL # \_\_\_\_\_

STACKER MODEL & SERIAL # \_\_\_\_\_

VALIDATOR SERIAL # \_\_\_\_\_

BILL DISPENSER SERIAL # \_\_\_\_\_

LOCK/KEY # \_\_\_\_\_

### Warranty Card

A warranty card is included in the documentation provided with HTK. Complete and return this card to Hamilton within ten (10) days of installation.

### Dedicated Power Source

Before installation, **ensure that HTK has its own dedicated power source**. Under no circumstances should additional equipment be operating off the dedicated power source for HTK. If a dedicated power source is unavailable, cease installation until one is established.

# Mechanical Installation

## Receiving and Unpacking HTK

When HTK is shipped, it is bolted to a pallet/skid with a cardboard box surrounding it for protection. This pallet contains the pay station only - bases (if ordered) will be in separate cardboard boxes.

Remove the cap screws that are securing the cardboard box to the pallet and slide the box off HTK.

**Figure 1.1:** HTK pallet (face)



**Figure 1.2:** HTK pallet (side)



Remove the two cardboard pads that are taped to the face (screen-side) of the HTK. Within these pads are the lock inserts, keys, and 'T' handle that is used to open the HTK door - remove and set aside. Remove the shrink wrap and the clear bag covering HTK.

### Save your keys

MAKE A PERMANENT RECORD OF THE NUMBERS ON THESE KEYS (see page 5).

### Open the HTK door

Use the 'T' handle to open the HTK door by inserting it into each lock cylinder and turning counter-clockwise.

### Remove the packing strap from the hoppers

Each hopper is shipped with a packing strap secured to it to minimize vibrations in transit. Cut the straps using wire cutters or sharp scissors.

### Remove the receipt paper

A roll of receipt paper is stored in one of the hoppers. Remove this for installation later.

### Remove all packing debris from the hoppers

During unpacking, ensure that debris does not fall into the hopper bowls. If this material is not removed, the hoppers could jam. With the power disconnected, remove any loose material inside the hopper bowls.

### Removal of additional packing materials

Remove the following to ensure proper operation:

- Strapping around XE validator (if optioned)
- Tape around Cashflow validator (if optioned)
- Tape around the coin mechanism
- Tape from the coin/token box
- Tape and paper on the front of the bill dispenser (if optioned)

## Remove HTK from the shipping pallet/skid

HTK is securely mounted to the pallet/skid with four (4) mounting bolts and nuts. With the main door open, unlock the vault door inside.

Loosen and remove the two nuts from the bolts inside the vault area. Repeat this process on the two bolts next to the power supply. Once this process is complete, you will be able to remove HTK from the pallet/skid.

## Positioning

There are no set guidelines for the placement of HTK. However, it is recommended that the machine is positioned far enough away from the wash entrance to minimize the amount of over spray that may reach the unit.

The recommended height from the pavement to the bottom of the HTK cabinet is approximately 24" - this ensures customers in most vehicle types can interact with HTK without excessive overreach.

## Mounting

HTK must be securely mounted by using one of the following methods:

### BRICK MOUNTING

Uses a custom-built brick or concrete enclosure to house HTK. See Figures 2.1 - 2.4 on pages 8 & 9 for mounting hole locations. HTK provides for six (6) 5/8" mounting holes. Have your engineer or contractor recommend a construction method suitable for strength and stability.

### BASE MOUNTING

This method involves mounting HTK on an optional base. The base is secured to the pavement or curb, and HTK is then secured to the base. The type of fasteners used should be recommended by your engineer as to strength and suitability.

## Running Conduit

Typical electrical code requires low and high voltage wiring to be run in separate conduits. HTK has three (3) 1-1/8" conduit mounting holes in the back of the cabinet (brick-in only), as well as six (6) 1-1/8" conduit holes in the bottom of the cabinet.

- Conduit carrying high voltage 120VAC power lines should be connected to either of the bottom two right conduit holes, or the one back right conduit hole (as viewed from the front of the machine). These conduits are designated only for 110v for the power supply.
- Conduit carrying lines with 24VAC, 24VDC, 12VAC or 12VDC signals should be connected to either one of the four bottom-left conduit holes, or either one of the back-left conduit holes.
- External communication lines (Cat 5 or Cat 5E, Video, POS etc.) should be run through separate conduit and connected to any of the open conduit holes on either the bottom-left or back-left of HTK.

**NOTE: free-standing cabinets do not have conduit holes in the back.**

# Dimensions: Brick-In Cabinet

**Figure 2.1:** Top of cabinet (looking down)

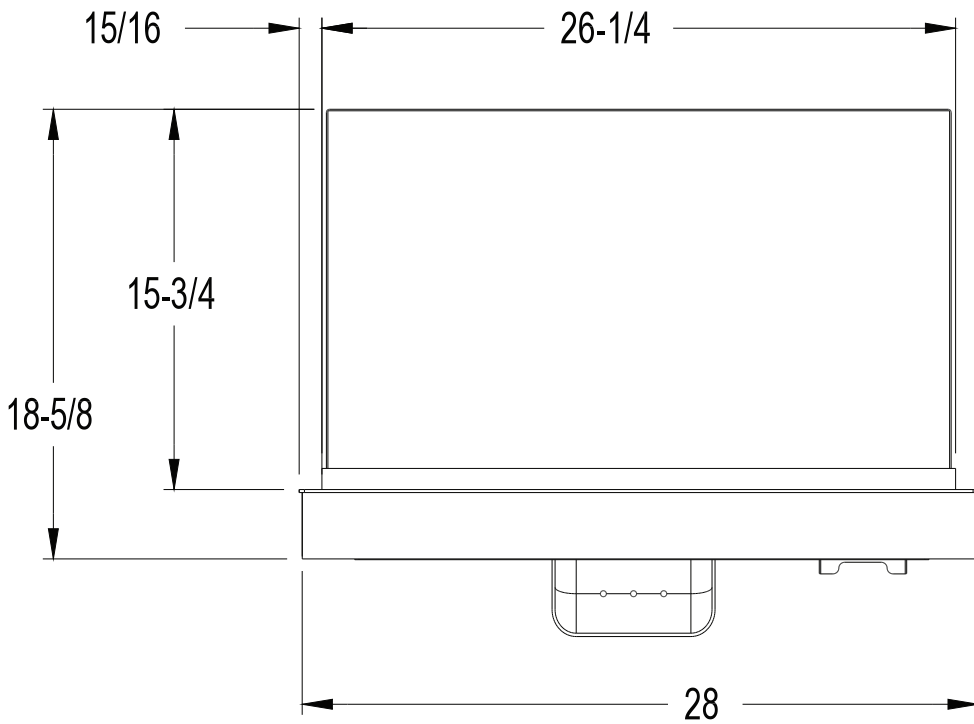

**Figure 2.2:** Base of cabinet (looking up)

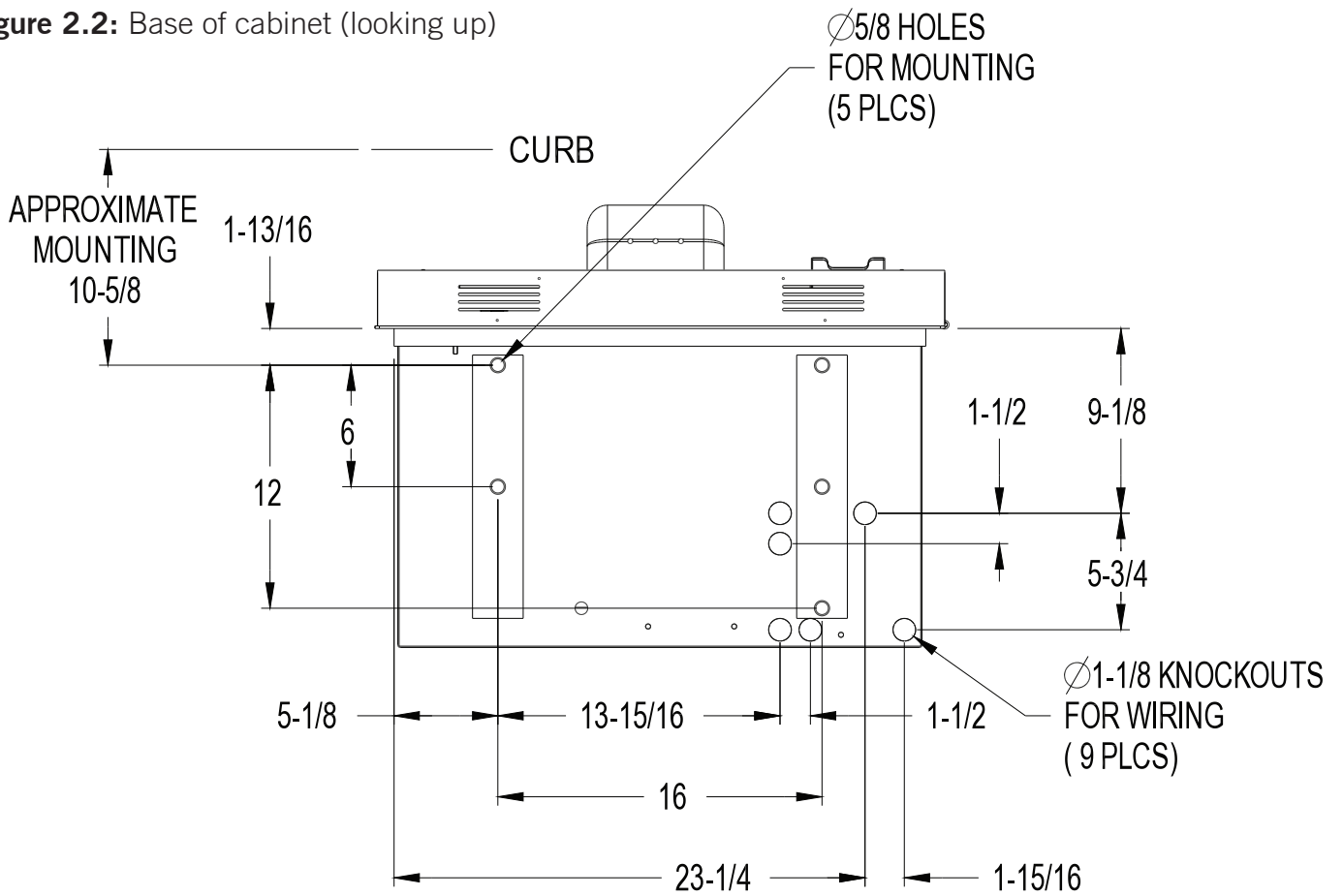

**Figure 2.3:** Side of cabinet

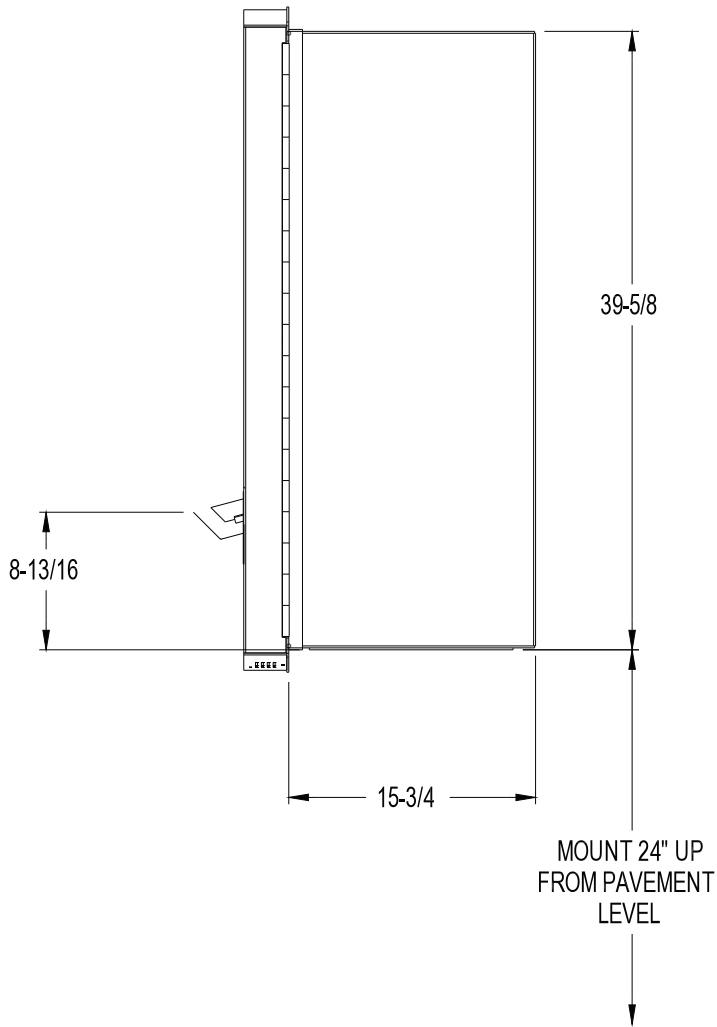

**Figure 2.4:** Rear of cabinet with conduit holes

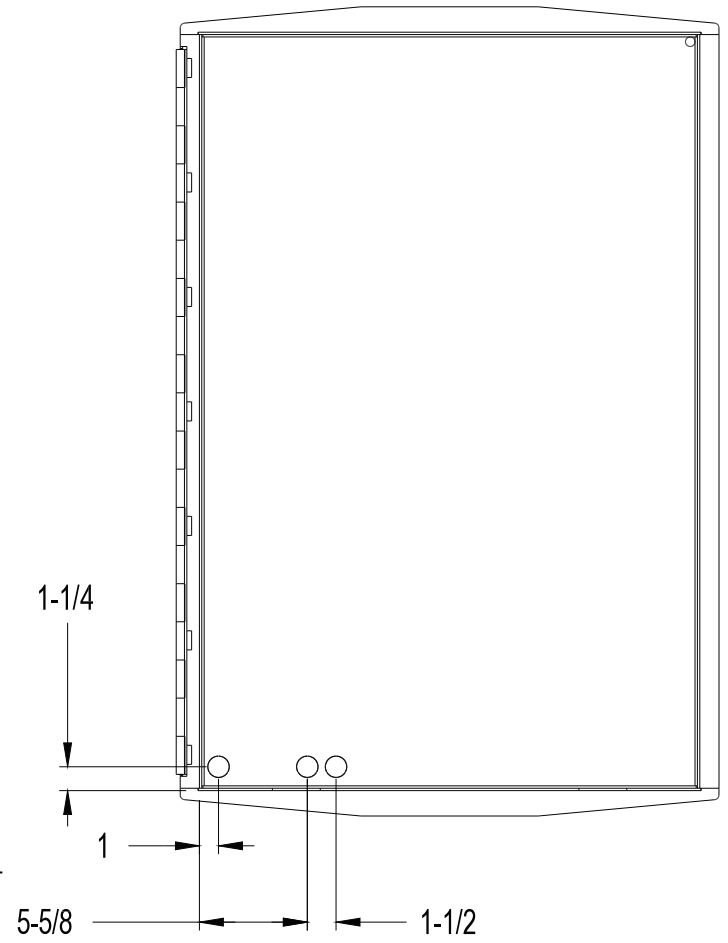
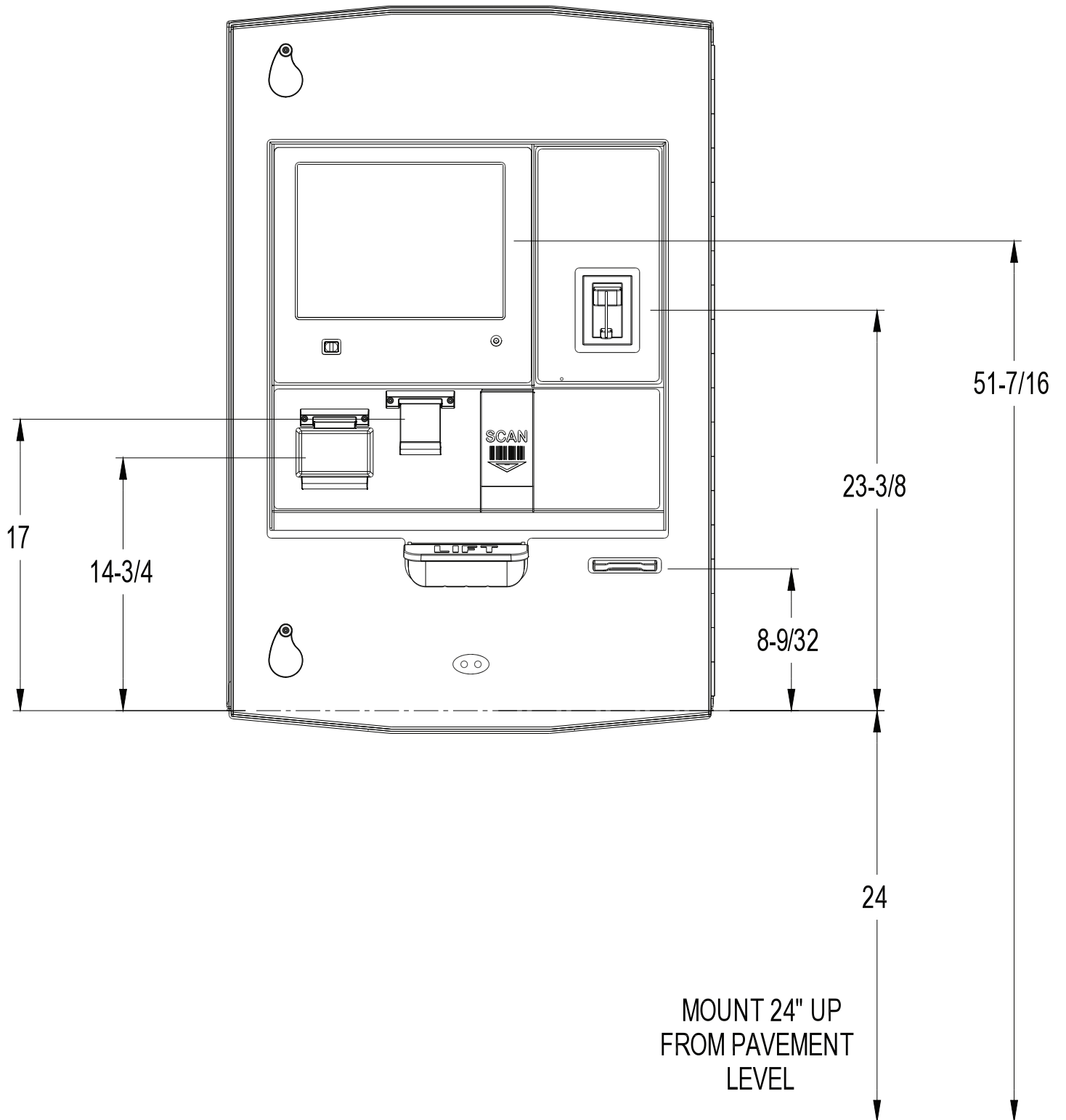
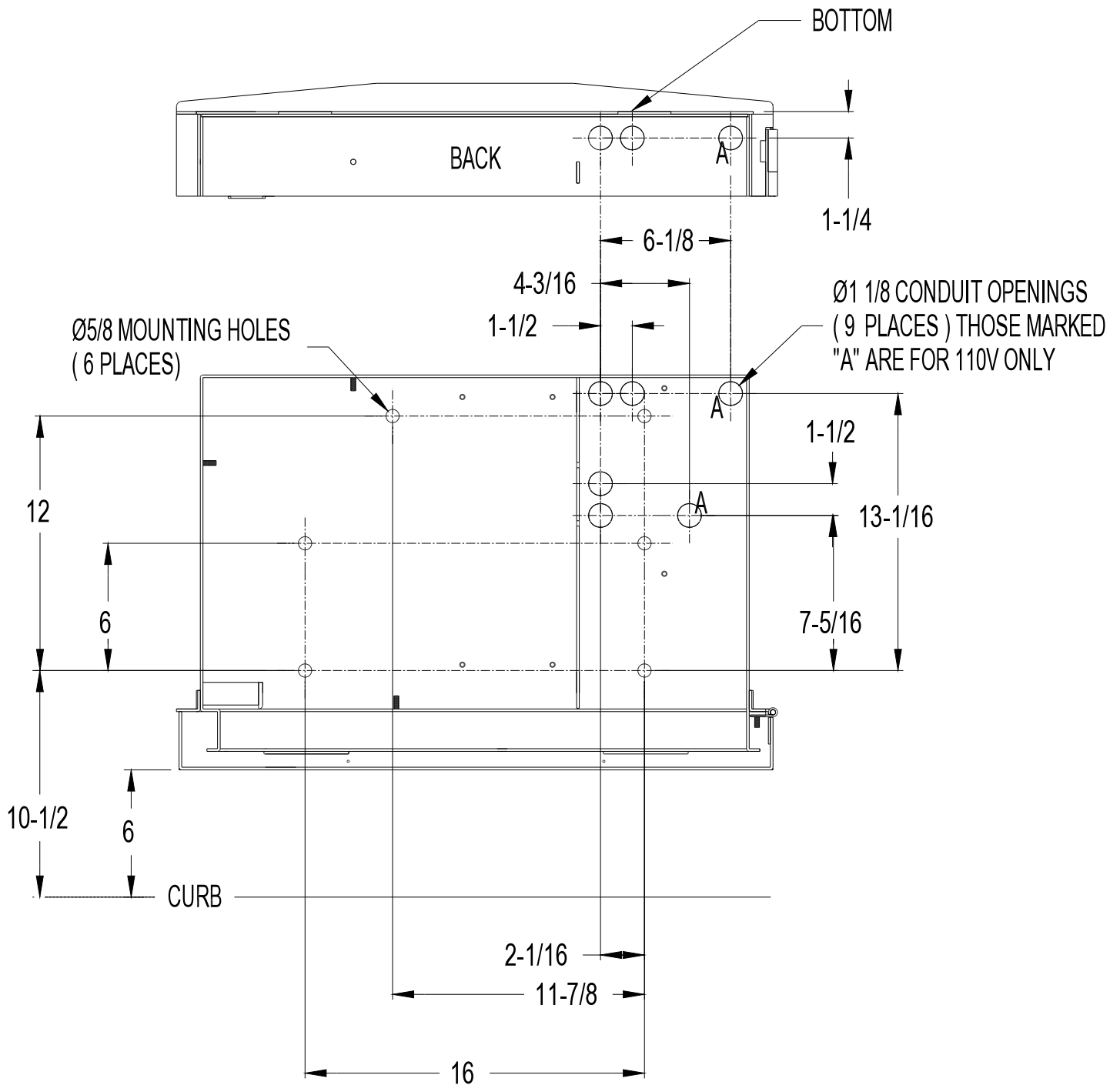

Figure 2.5: Door



# Brick-In Bolt Pattern

**Figure 3.1:** Brick-in HTK bolt pattern (looking down)



**All foundations must be level and flat.**

**Verification of site-specific conditions and compliance with Federal, State, and Local building codes is the exclusive responsibility of the customer and/or architect and engineer.**

# Dimensions: Free-Standing Cabinet

**Figure 4.1:** Top of cabinet (looking down)

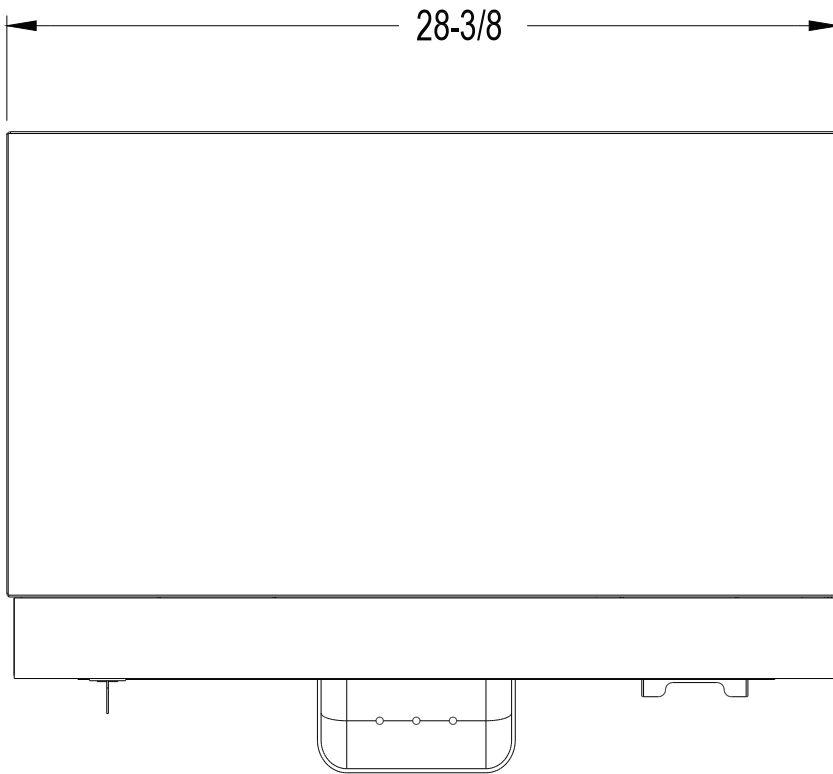

**Figure 4.2:** Base of cabinet (looking up)

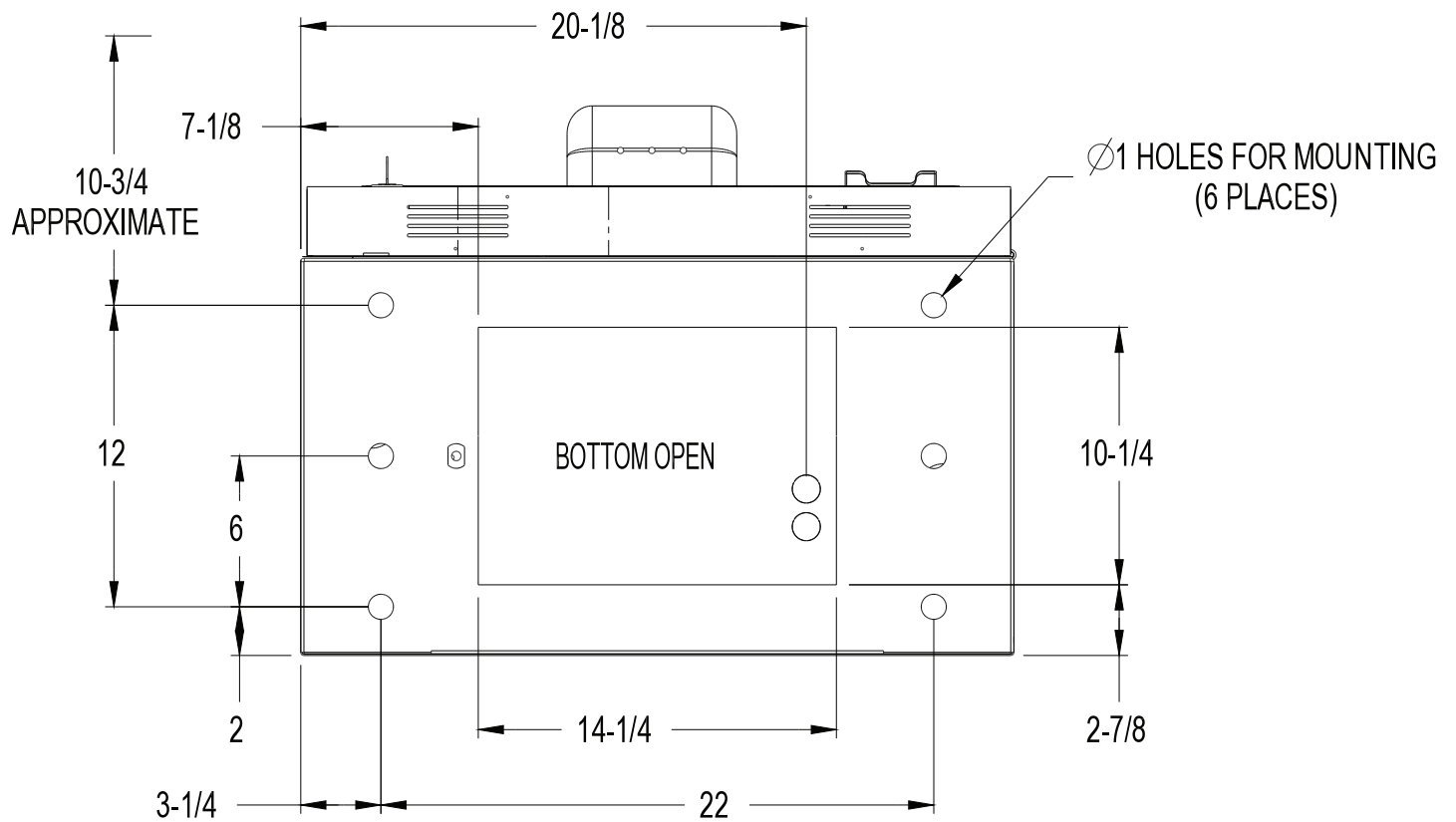

**Figure 4.3:** Sides of cabinet

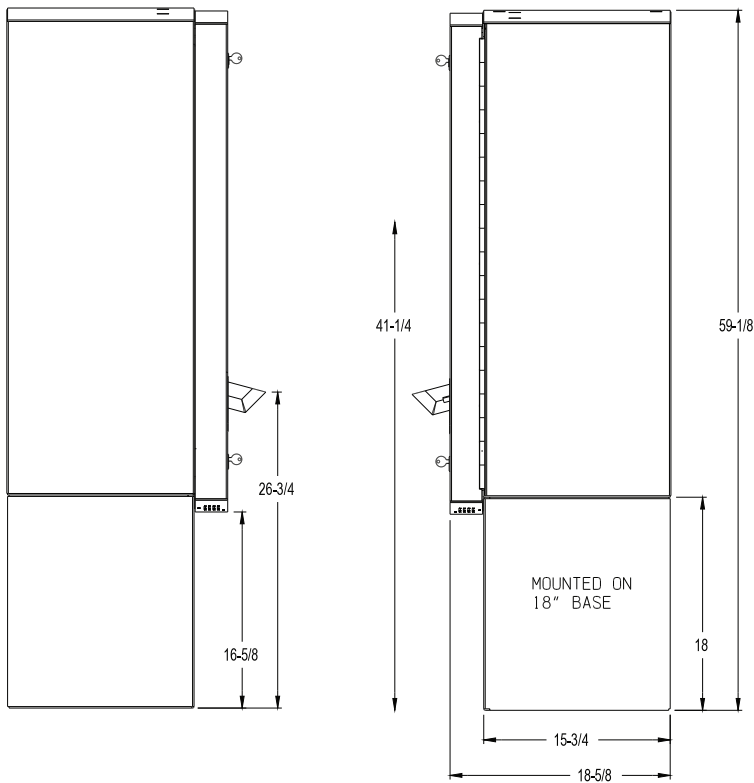

**Figure 4.4:** Rear of cabinet

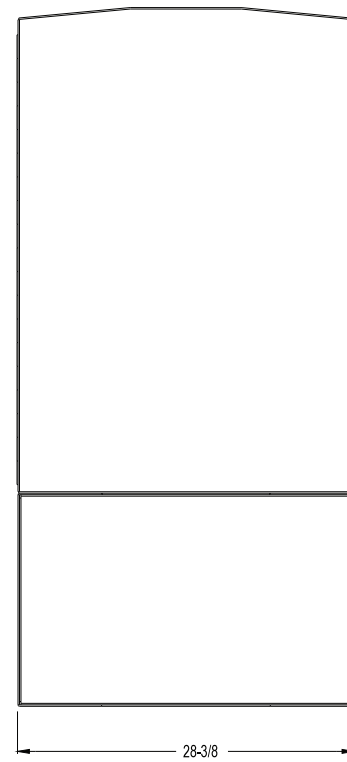

**Figure 4.5:** Door & base of HTK

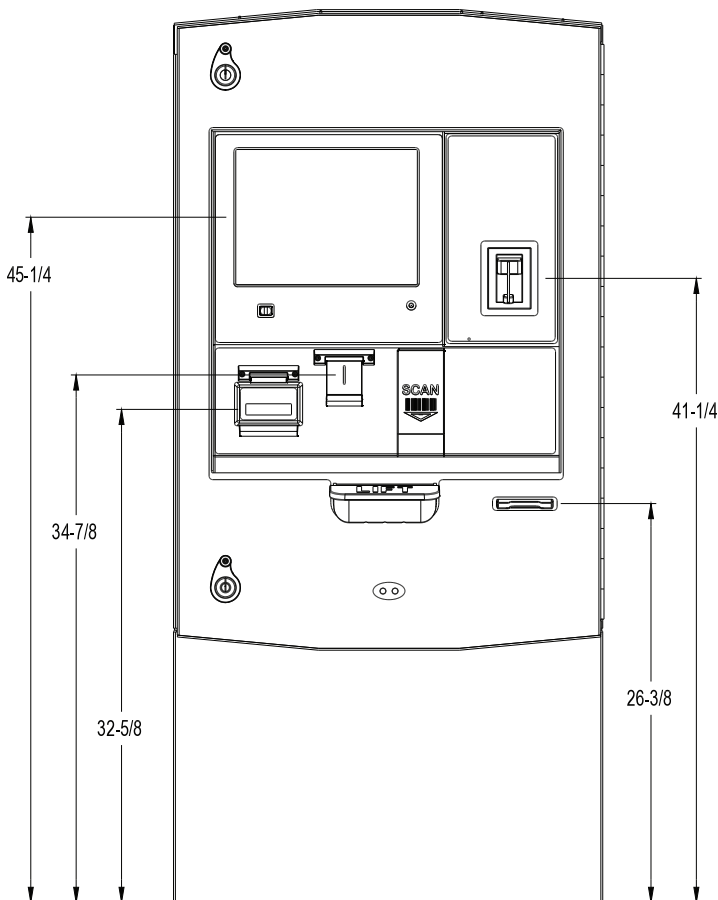

**NOTE:** free-standing cabinets do not have conduit holes in the back of the cabinet.



# Lane Layouts

If you are using gates at your facility, use the following drawings to assist in placement and installation.

**Figure 6.1:** Front view of brick-in lane layout

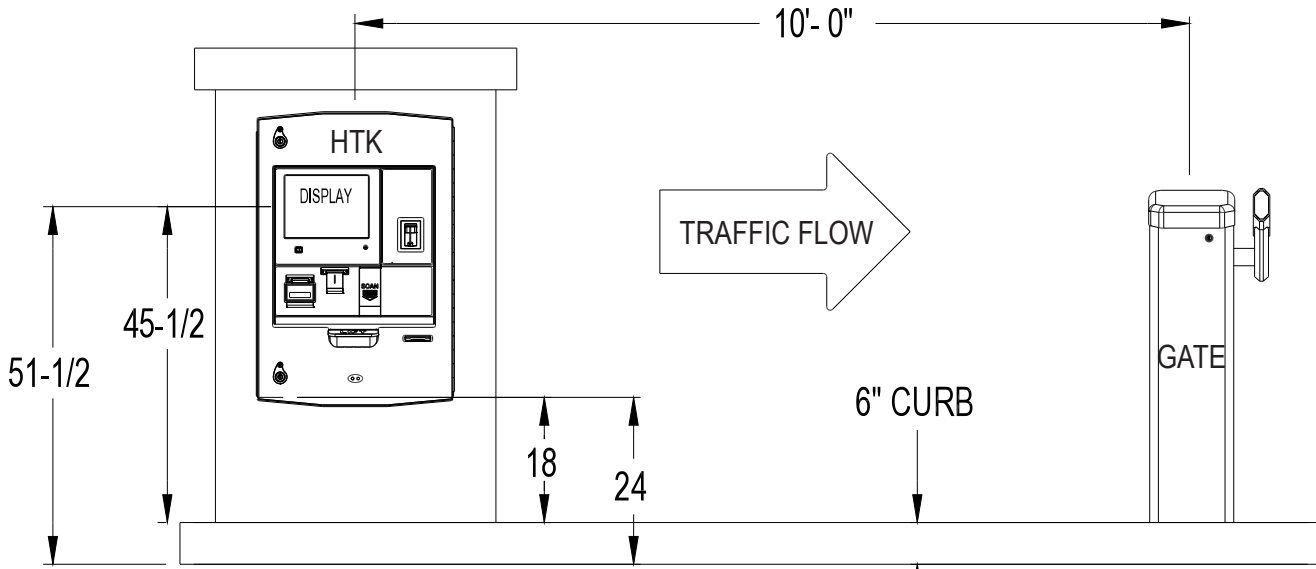

**Figure 6.2:** Front view of free-standing lane layout

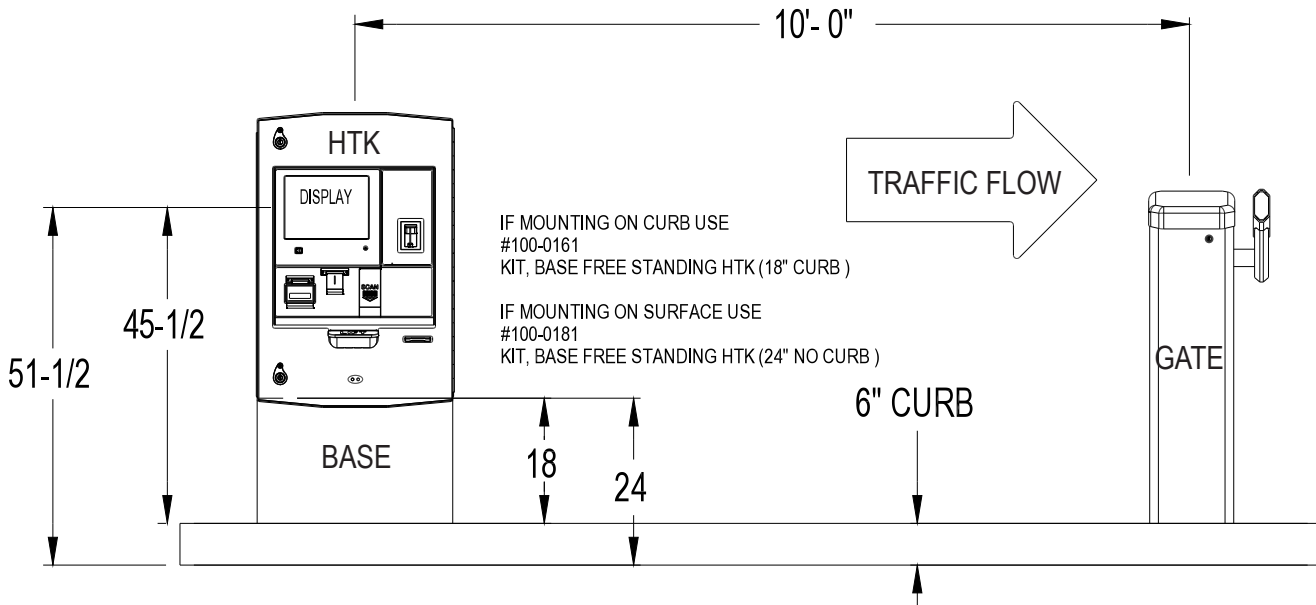

WIRING CONNECTIONS	
POWER FOR KIOSK	1-14 AWG MINIMUM-HOT-BLACK 1-14 AWG MINIMUM-NEUTRAL-WHITE 1-14 AWG MINIMUM-GROUND-GREEN
POWER FOR GATE	1-14 AWG MINIMUM-HOT-BLACK 1-14 AWG MINIMUM-NEUTRAL-WHITE 1-14 AWG MINIMUM-GROUND-GREEN
COMMUNICATION TO KIOSK FROM NETWORK SWITCH	1 - CAT5 ETHERNET CABLE
COMMUNICATION BETWEEN KIOSK & GATE	1-22 AWG MINIMUM - GATE UP 1-22 AWG MINIMUM - COMMON 1-22 AWG MINIMUM - SAFETY LOOP STATUS 1-22 AWG MINIMUM - + 24v

**Figure 6.3:** Overhead view of lane layout

- 1) This drawing shows a conventional layout for access control.
- 2) Curb height is typically 6"
- 3) See gate manufacturers guidelines for foundation and loop installation
- 4) All foundations must be level and flat
- 5) Verification of site conditions and compliance with Federal, State, and Local Building Codes is the exclusive responsibility of the business owner and/or architect

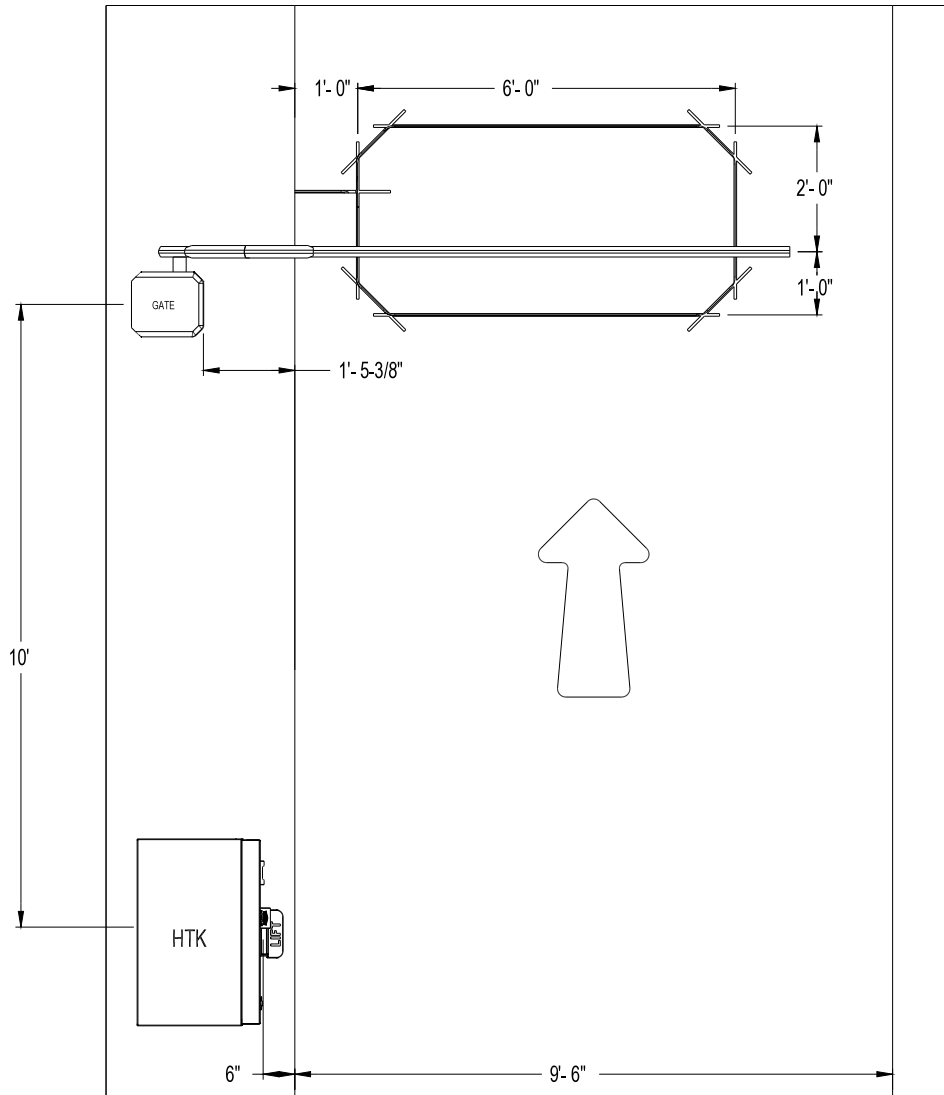

### GATE ORIENTATION

The service door on the gate should be facing INTO the lane.

If mounted incorrectly, the arm will close in the opposite direction.

**Figure 6.4:** Service door orientation

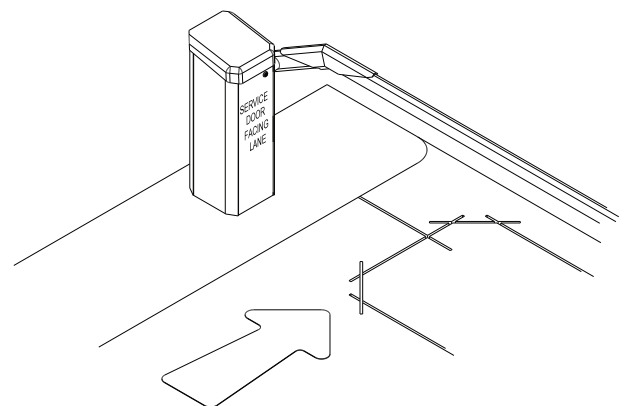

# Electrical Installation



**CAUTION! TO AVOID SEVERE INJURY OR DEATH, ALWAYS DISCONNECT POWER TO THE MACHINE WHILE SERVICING. ALL ELECTRICAL WORK MUST BE PERFORMED BY A QUALIFIED ELECTRICAL CONTRACTOR.**

HTK operates on **120 VAC, 60 Hz** with a Constant Voltage Transformer (CVT). This unit must be hard-wired with conduit, and requires a dedicated power source. Under no circumstances should additional equipment be operating off the dedicated power source for HTK.

If a dedicated power source is unavailable, cease installation until one is established.

## Pulling Wires

The number of wires that must be pulled for HTK are shown in the table below:

THREE (3) WIRES	<b>Electrical power (Hot, Neutral, and Ground)</b>
NINE (9) WIRES	<b>Eight (8) for washes*, one (1) common</b>
TWO (2) WIRES	<b>Cycle inhibit</b>
TWO (2) WIRES <i>Optional</i>	<b>Wash in Service (WIS)</b>
TWO (2) WIRES	<b>Out of Service relay</b>
SPARE WIRES	<b>For future options</b>
TWO (2) CONDUCTOR TWISTED SHIELDED CABLE <i>Optional</i>	<b>Hamilton Code System / POS 4000</b>
CAT5	<b>Credit Card, Gift Card, and Hosted Solutions</b>
Shielded Video Cable	<b>Video/Camera</b>

\* *The Wash Interface supports up to eight (8) washes. If only offering four washes, you may pull five (5) wires instead of nine (9) (four (4) for washes, one (1) common)*

**For proper operation of HTK, the wires listed above must be pulled and terminated as explained on the following pages.**

# Wire Terminations

The wire terminations should proceed as follows:

## **CVT & POWER SUPPLY** (see Figure 7.1)

One side of the three power supply wires (120VAC HOT, 120VAC NEU, and 120VAC GND) should be attached directly to the electrical service panel supplying power to the installation. One end of this cable is already connected to the CVT.

The exposed end of the power cable will make the connection between the HTK CVT and the site's electrical panel. This connection should be made with 14AWG wire and a 15AMP breaker at the site's electrical panel, and terminated in a field-wiring compartment. Wiring must remain accessible **after installation** for inspection purposes.

---

## **VENDS 1-8** (see Figure 7.2)

Vend lines 1-8 are connected to the phoenix connector at positions 1-8 respectively. They are used to signal to the car wash controller which wash package and buy-up items have been selected.

**NOTE: the signal presented to the car wash controller is normally an open, dry contact relay closure.**

---

## **COMMON WIRE** (see Figure 7.2)

The Common Wire pulled to HTK from the car wash controller is connected in Position 11 (C) of the phoenix connector on the Wash Interface.

---

## **CYCLE/INHIBIT** (see Figure 7.2)

The Cycle/Inhibit wires are used for the car wash controller to signal HTK when a car has completed its wash and left the bay. The signal coming from the car wash controller must be able to energize the coil of a relay on the wash interface. This means that the car wash controller must be supplying both voltage and current when it energizes the coil.

Inside HTK, the wiring connection depends on the signal provided by the car wash controller. The Cycle/Inhibit wires should be connected directly to the 4 position phoenix connector, and position 1 and 2 on the wash interface.

---

## **WASH IN SERVICE (WIS) Signal - *Optional*** (see Figure 7.2)

Some wash equipment manufacturers will use this to place the pay station into an 'Out of Service' mode, separate from the cycle inhibit signals. This may also be used for an operator to manually put HTK into an 'Out of Service' mode. This will stop HTK from processing any further transactions until the state has changed.

## **OUT OF SERVICE** (see Figure 8.5)

An Out of Service relay is included in HTK. The connection is made at a 3 position phoenix connector on the distribution board. Position 1 (common), Position 2 (normally closed) and Position 3 (normally open).

---

## **485 COMMUNICATION LINE - *Optional*** (see Figure 8.5)

If a Hamilton Code System or POS 4000 is being used in conjunction with HTK, a 485 communication line must be pulled to each HTK on site. Cable (1 pair, twisted, shielded) should be run from where the connection to the Code System device (isolator box) is located back to HTK.

The connection to HTK is on a 2 position phoenix connector on the distribution board. Position 1 is the positive, and Position 2 is the negative. The 485 Communication Line can be run in with low voltage wires coming from the car wash.

***NOTE: the 485 run should be made without any splicing or mid-point connections. If there are, this can lead to communication issues. The maximum length of 485 cable is 1,000ft.***

---

## **CAMERA - *Optional***

If you wish to tie HTK's standard camera into a camera system, a video cable (shielded coaxial cable) should be pulled to each pay station on site. The cable should run (without any splicing or mid-point connections) from where the connection to the camera system is located back to the HTK(s).

---

## **HELP BUTTON - *Optional***

The 'Help' button is a set of contacts that close when the button is pressed. It is designed to be connected to a third-party intercom system. Two 18-gauge wires should be pulled from where the intercom system is located back to the HTK(s). These wires can be run in with low voltage wires coming from the car wash.

# Electrical Diagrams

**Figure 7.1:** Power supply wiring connection

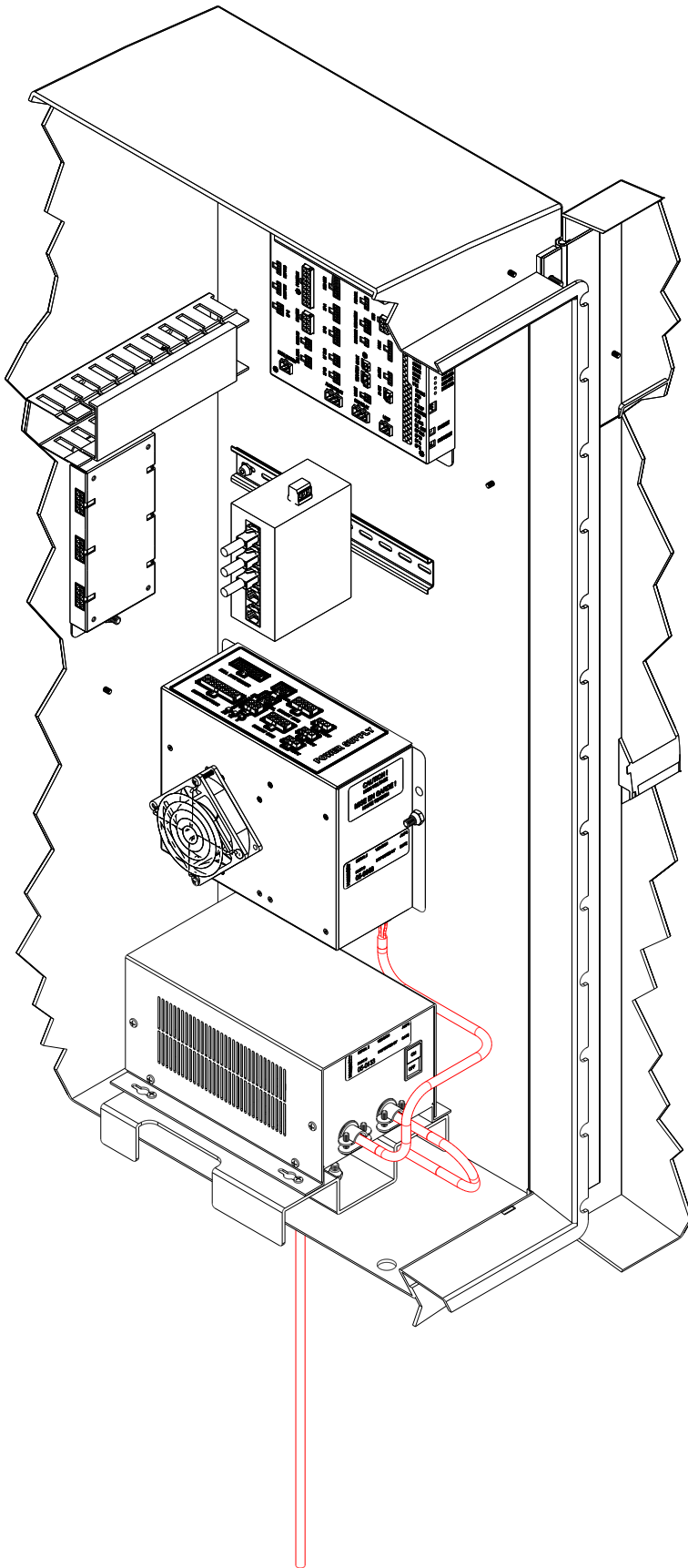

The exposed end of the power cable will make the connection between the HTK CVT and the site's electrical panel. This should be terminated in a field-wiring compartment.

THE POWER SUPPLY SHOULD NOT BE REMOVED TO MAKE CONNECTION TO THE SITE'S ELECTRICAL PANEL.

**Figure 7.2:** Wash Interface diagram

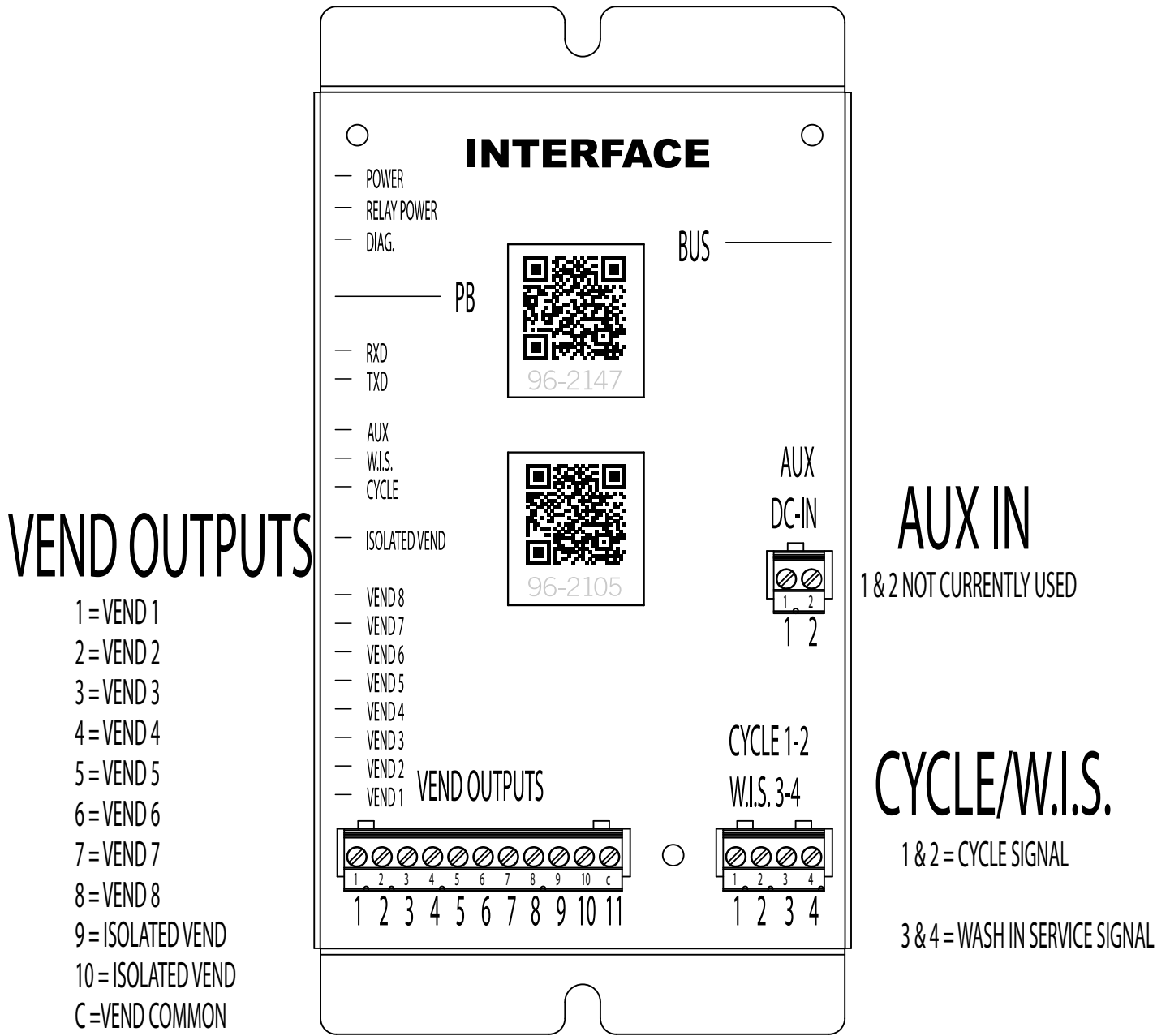

**Figure 7.3:** Wash Interface diagram, angled

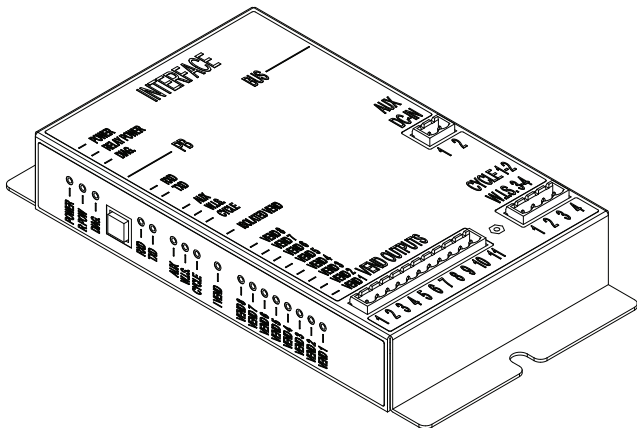

**Figure 7.4:** Gated Sequence Software Ether Vend (MIB Gate)

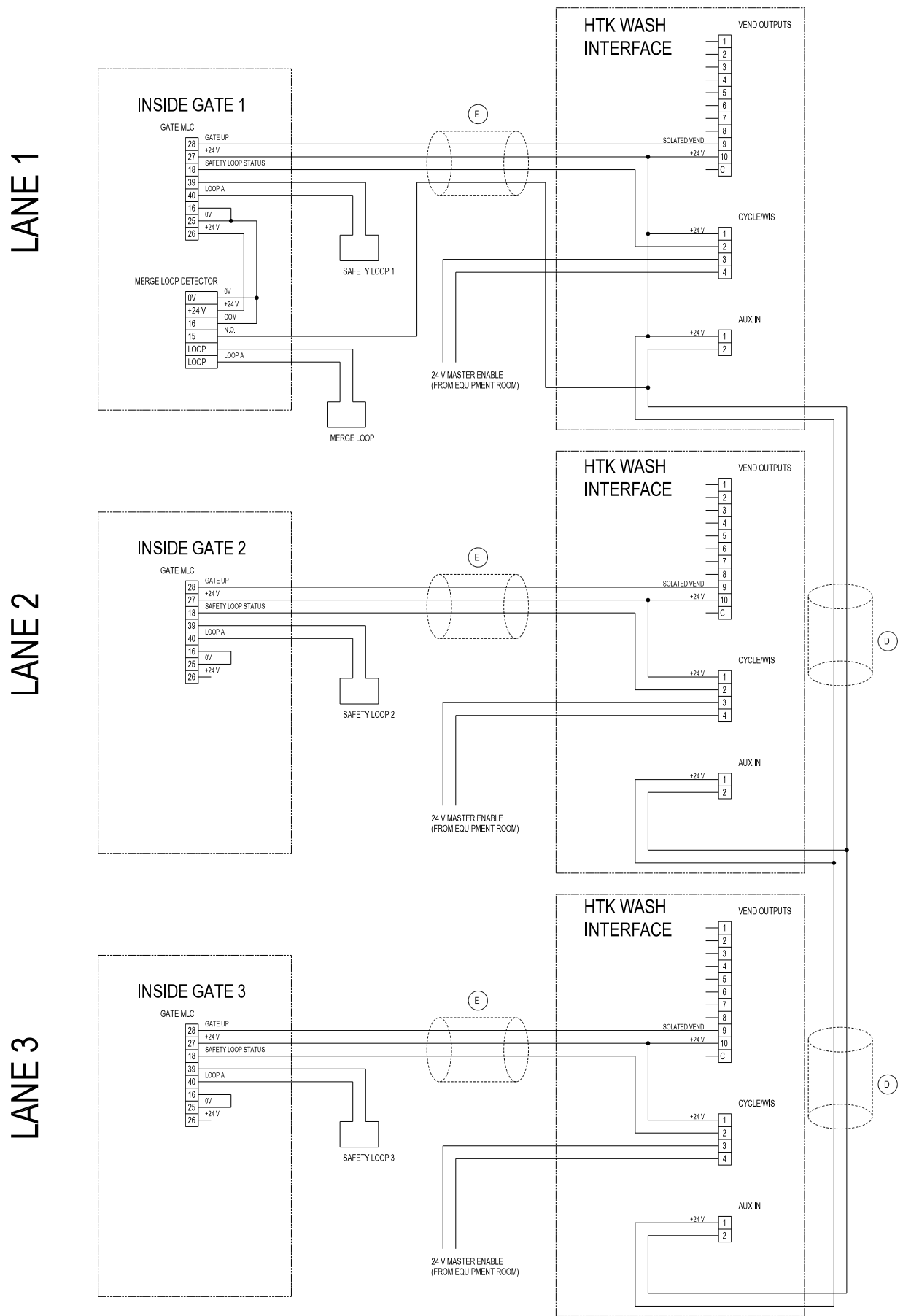

**Figure 7.5:** Gated Sequence Software Ether Vend (Micro Drive Gate)

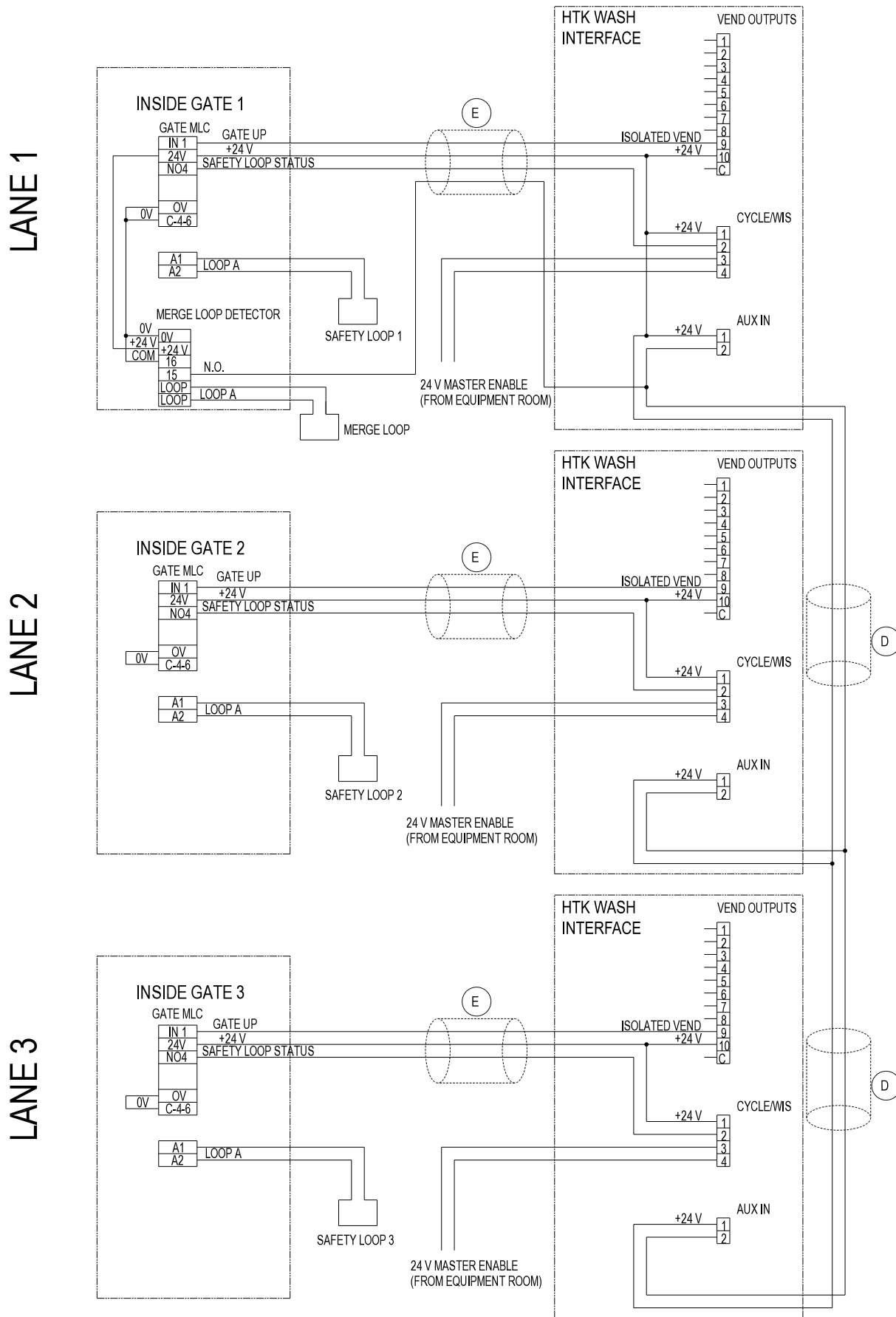

# Setting the Car Wash Cycle Synchronization

The Car Wash Cycle Synchronization is a programmable setting in the HTK controller. The proper setting of this category depends on the equipment used in your car wash system.

If the car wash equipment normally leaves the CYCLE/INHIBIT RELAY de-energized while in standby, and then energizes the relay when the customer enters the bay, the programming category should be set to PASSIVE.

If the reverse occurs, where the car wash equipment normally energizes the CYCLE/INHIBIT RELAY while in standby, then de-energizes the relay when the customer enters the bay, the programming category should be set to ACTIVE.

**Figure 7.6:** Passive Cycles

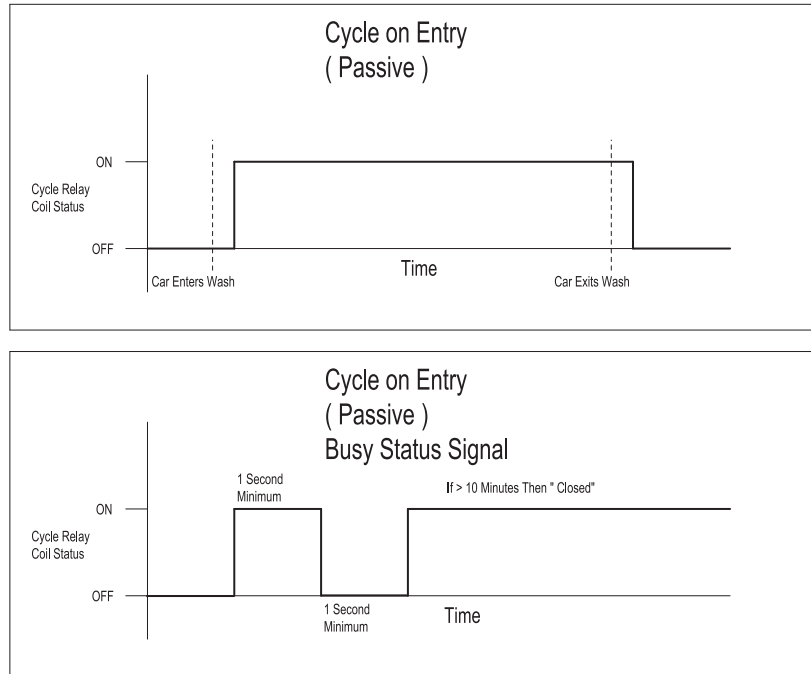

**Figure 7.7:** Active Cycles

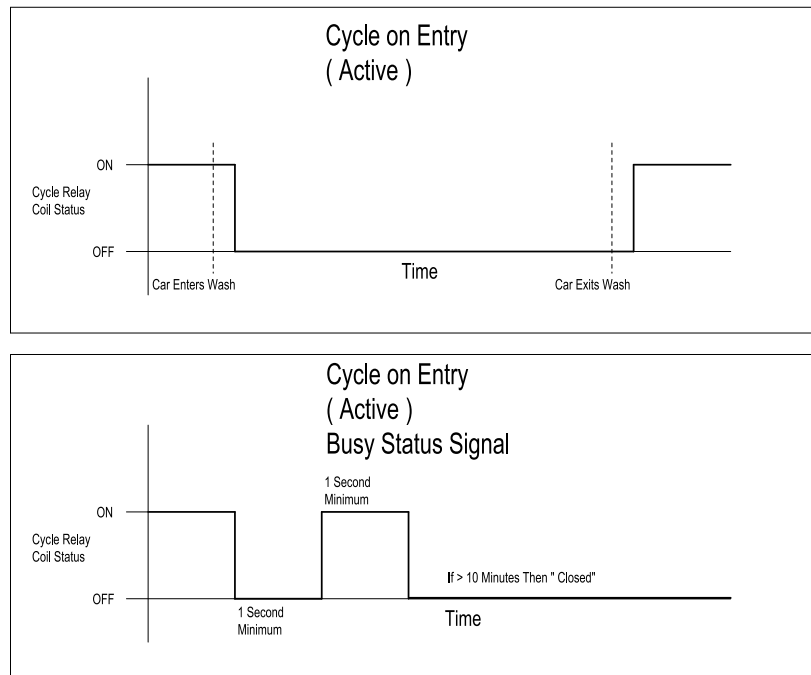

# Component Connections

This section provides schematics of the harness connections to the **power supply, controller, distribution board, Smart Bus Hub, bill dispenser, and stacker interface.**

## Power Supply

**Figure 8.1:** Power supply connections

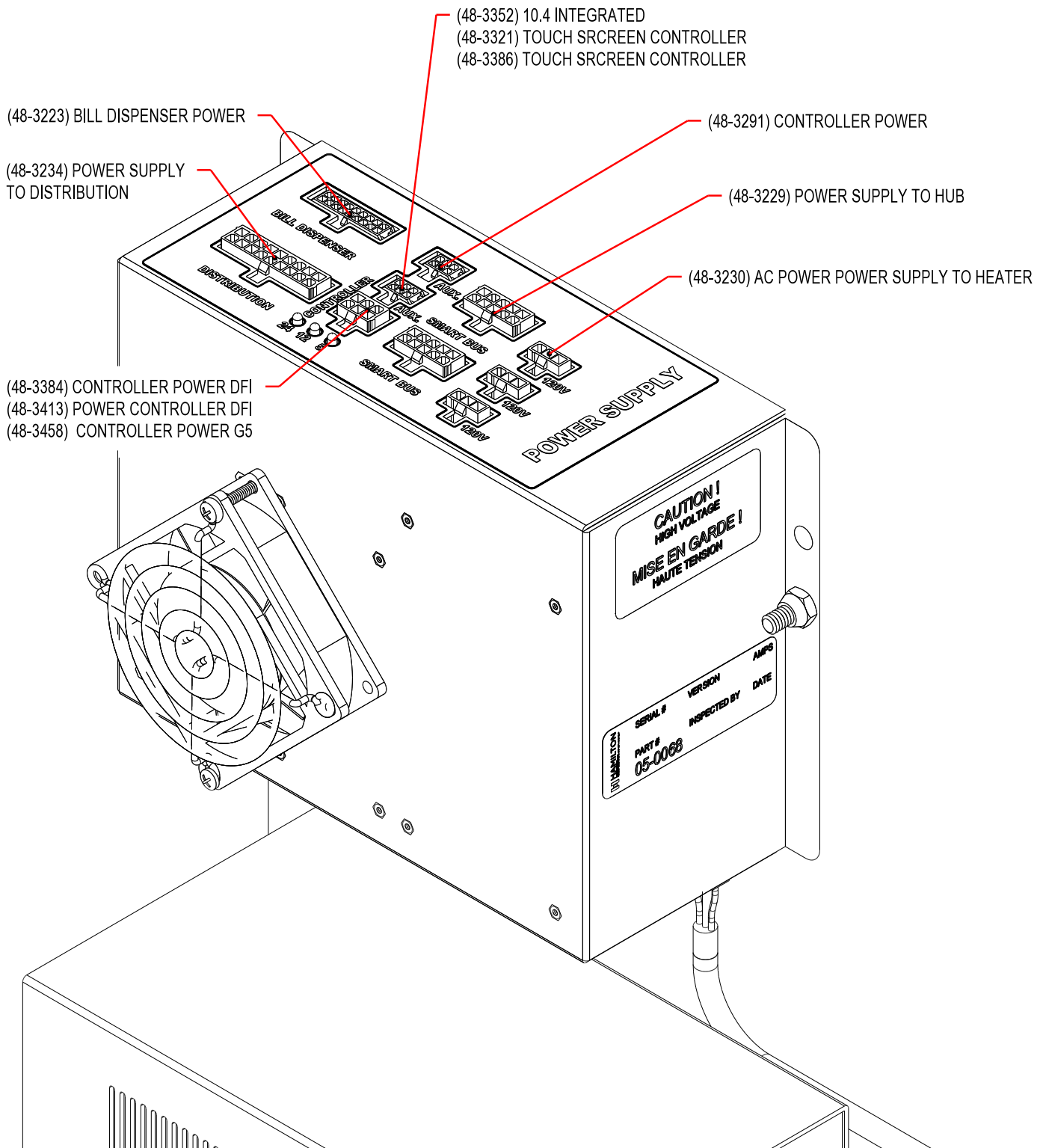

# Controller

**Figure 8.2:** Gen5 controller connections

**NOTE:** the power button is located on the side of the controller facing the back of the cabinet. When powering down HTK, it is strongly recommended to turn off the controller here before the main power switch on the CVT.

**TO TURN OFF:** press and hold the power button until the screen turns off. Then, turn off main power at the CVT.

**TO TURN ON:** turn on the main power switch on the CVT; the controller will automatically turn on at the same time.

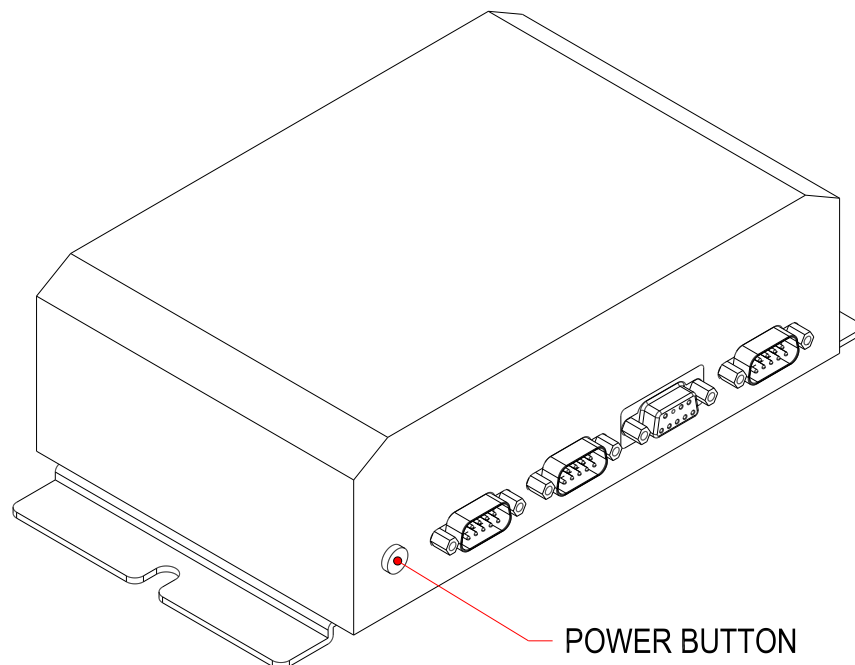
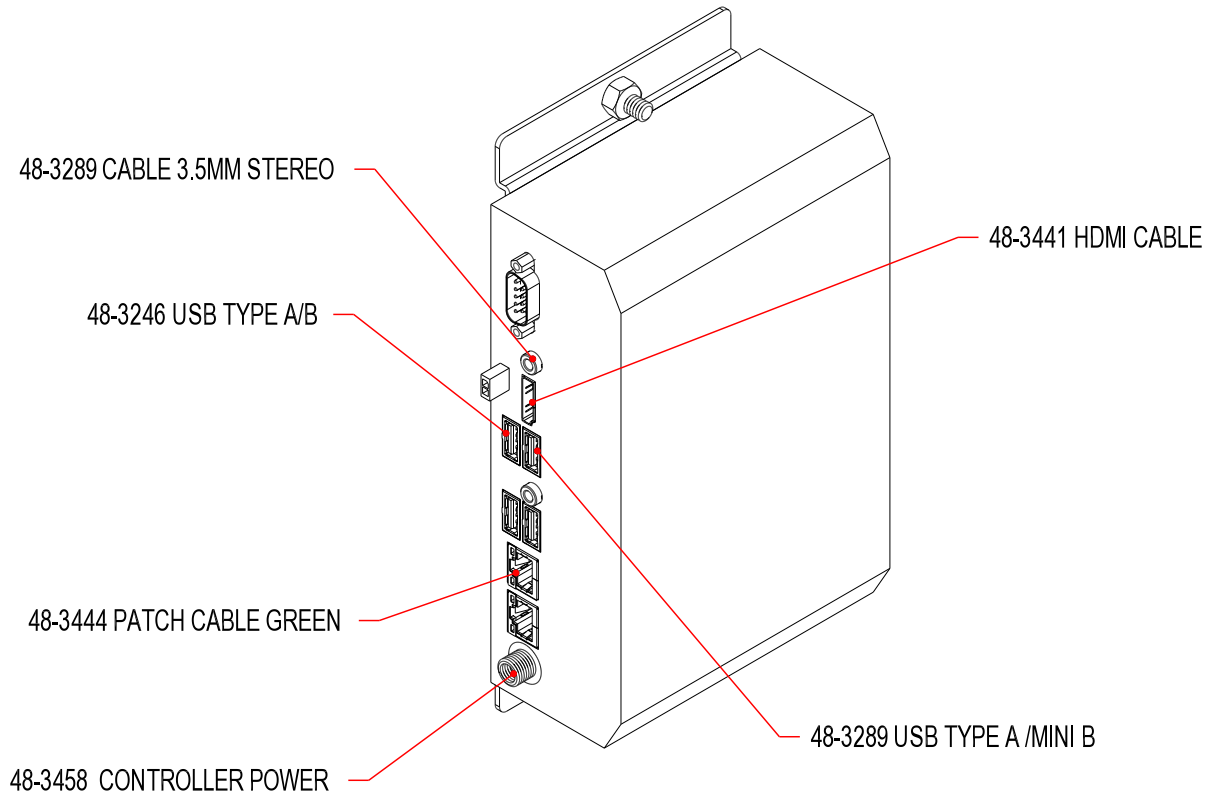

### Figure 8.3: Gen4 controller connections

**NOTE:** the power button is located on the side of the controller facing the back of the cabinet. When powering down HTK, it is strongly recommended to turn off the controller here before the main power switch on the CVT.

**TO TURN OFF:** press and hold the power button until the screen turns off. Then, turn off main power at the CVT.

**TO TURN ON:** turn on the main power switch on the CVT; the controller will automatically turn on at the same time.

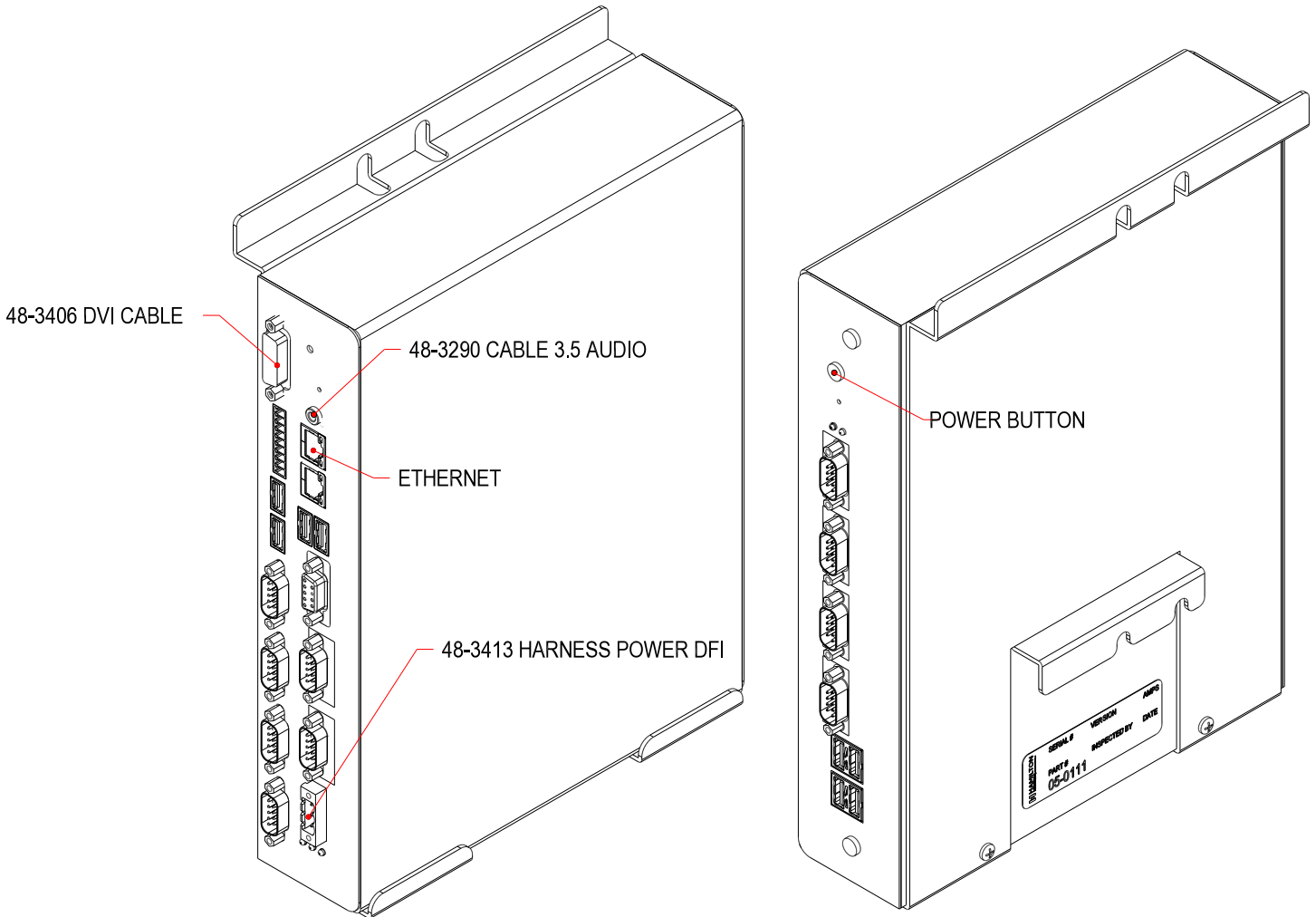



# Distribution Board

**Figure 8.5:** Distribution board connections

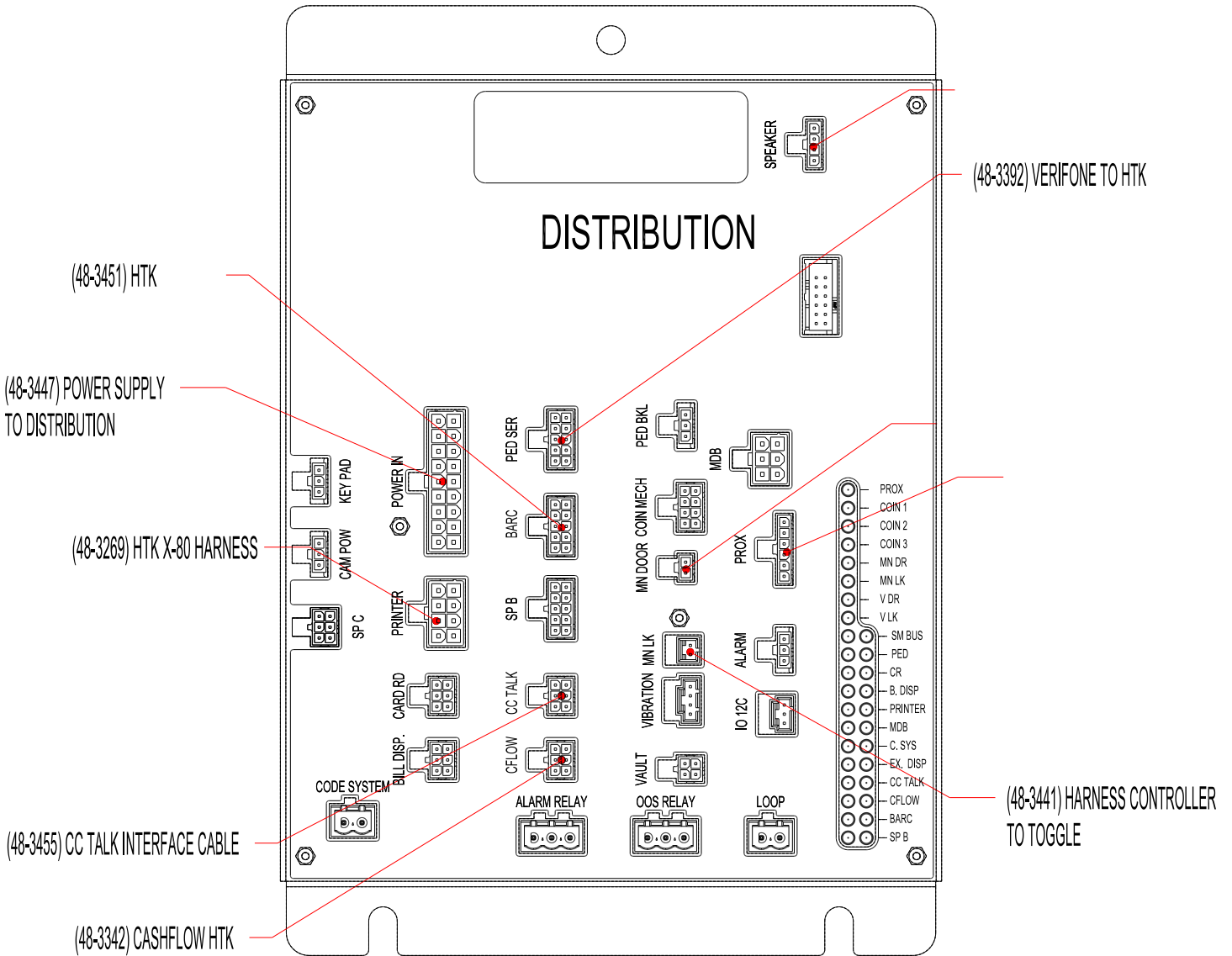

# Smart Bus Hub

**Figure 8.6:** Smart Bus Hub connections

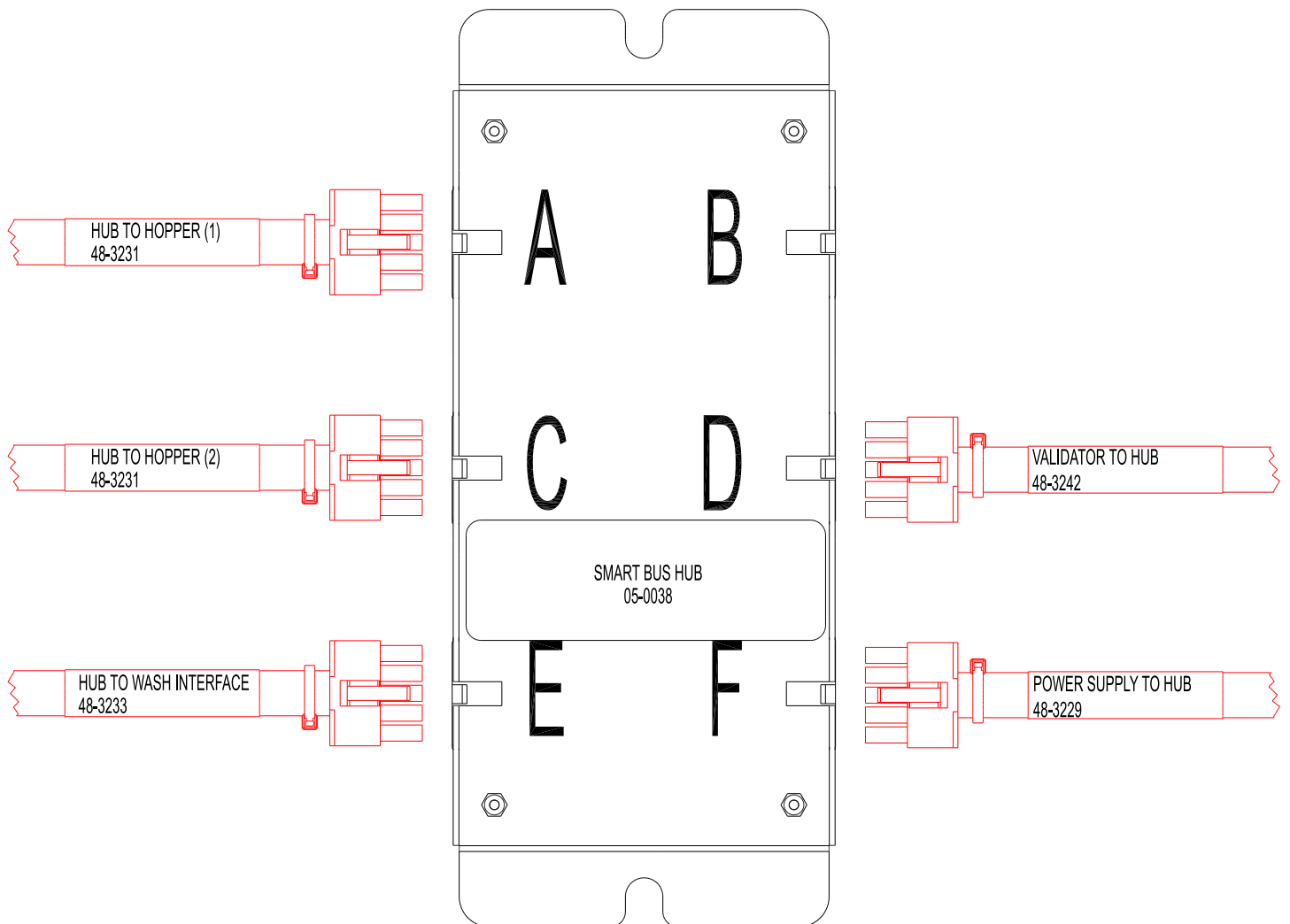

# Bill Dispenser

**Figure 8.7:** Bill dispenser connections

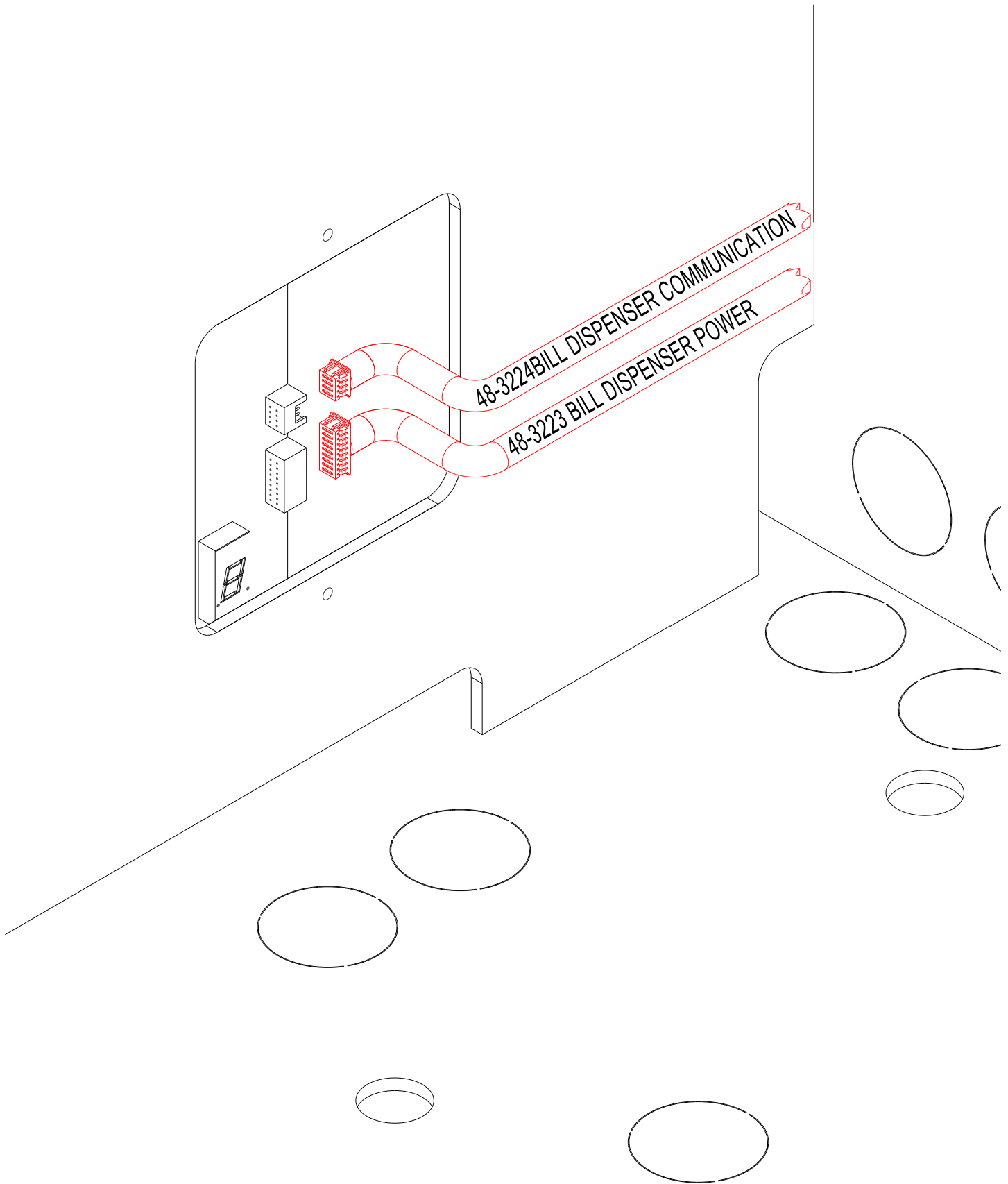

# Stacker Interface

**Figure 8.8:** Stacker interface connections

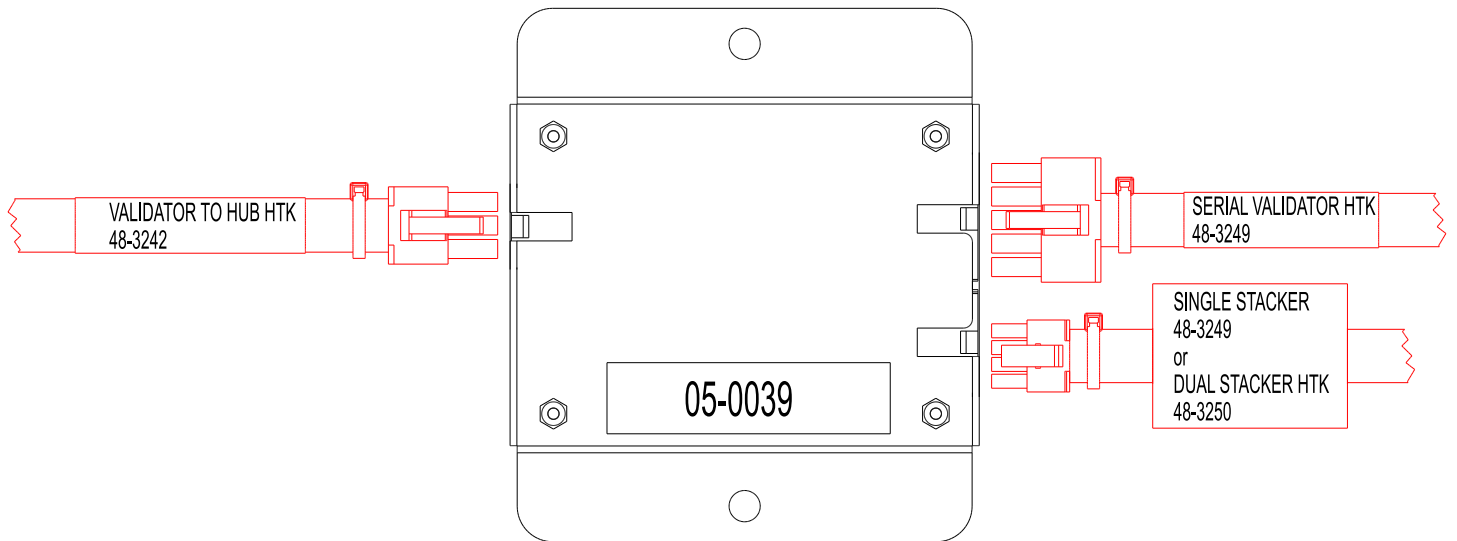

# Gate & Loop References

---

For general information on the Magnetic Access Pro gates offered by Hamilton, visit [www.magnetic-access.com/en-US/products/barriers/access/access-pro-l.html](http://www.magnetic-access.com/en-US/products/barriers/access/access-pro-l.html)

To download operating instructions, visit Hamilton's website at [www.hamiltonmfg.com/documentation](http://www.hamiltonmfg.com/documentation) and search for 'Magnetic'.

# Warranty

---

## LIMITED WARRANTY AGREEMENT OF HAMILTON MANUFACTURING CORP.

Hamilton Manufacturing Corp., an Ohio Corporation, (“Seller”) warrants to Purchaser that all new equipment shall be free from defects in material and factory workmanship for a period of one (1) year from the original shipping date.

Hamilton Manufacturing Corp. further warrants if any part of said new equipment in Seller’s sole opinion, requires replacement or repair due to a defect in material or factory workmanship during said period, Seller will repair or replace said new equipment.

Purchaser’s remedies and the liabilities and obligations of Seller herein shall be limited to repair or replacement of the equipment as Seller may choose, and Seller’s obligation to remedy such defects shall not exceed the Purchaser’s original cost for the equipment. Purchaser EXPRESSLY AGREES this is the EXCLUSIVE REMEDY under this warranty. There are no other express or implied warranties which extend beyond the face hereof.

All warranty repair service must be performed by either a Factory Trained Service Representative or HAMILTON MANUFACTURING CORP., 1026 Hamilton Drive, Holland, Ohio 43528 PHONE (419) 867-4858 FAX (419) 867-4867.

The limited warranty for new equipment is conditioned upon the following:

1. The subject equipment has not, in the Seller’s sole opinion, been subjected to: accident, abuse, misuse, vandalism, civil disobedience, riots, acts of God, natural disaster, acts of war or terrorism.
2. The Seller shall not be liable for any expense incurred by Purchaser incidental to the repair or replacement of equipment and Purchaser shall assume full responsibility for any freight or shipping charges.
3. The coverage of this warranty shall not extend to expendable parts.
4. Purchaser shall have a warranty registration card on file with Seller prior to any claim in order for warranty protection to apply.
5. No warranty coverage is applicable to any equipment used for currency other than that specified at the time of the purchase.
6. Seller expressly disclaims any warranty that counterfeit currency will not activate said equipment.
7. Seller expressly disclaims any warranty for any losses due to bill manipulation or theft or loss of cash under any circumstances.
8. Use of the equipment for anything other than its intended and designed use will void the Limited Warranty Agreement. Use of equipment for anything other than its intended and designed use includes, but is not limited to, downloading software/applications not certified by Seller such as e-mail, spyware, screen savers, viruses, worms, third party software, web search engines, cookies, spam, desktop applications, games, web surfing, etc.

Seller further warrants all repair or service work performed by a factory trained representative or Hamilton Manufacturing Corp. for a period of ninety (90) days from the date the repair or service work was performed. Purchaser's remedies and the liabilities and obligations of Seller herein shall be limited to repair or replacement of equipment as Seller may choose, and Seller's obligation to remedy such defects shall not exceed the Purchaser's depreciated value of the equipment. Purchaser EXPRESSLY AGREES this is an EXCLUSIVE REMEDY under this warranty.

There are no other express or implied warranties on repair or service work performed by a factory trained representative or Hamilton Manufacturing Corp. which extend beyond the face hereof. The limited warranty for repair and service work is conditioned upon the following:

1. The subject equipment has not, in the Seller's sole opinion, been subjected to: accident, abuse, misuse, vandalism, civil disobedience, riots, acts of God, natural disaster, acts of war or terrorism.
2. The Seller shall not be liable for any expense incurred by Purchaser incidental to the repair or replacement of equipment and Purchaser shall assume full responsibility for any freight or shipping charges.
3. The coverage of this warranty shall not extend to expendable parts.
4. Purchaser shall have a warranty registration card on file with Seller prior to any claim in order for warranty protection to apply.
5. No warranty coverage is applicable to any equipment used for currency other than that specified at the time of the purchase.
6. Seller expressly disclaims any warranty that counterfeit currency will not activate said equipment.
7. Seller expressly disclaims any warranty for any losses due to bill manipulation or theft or loss of cash under any circumstances.
8. No person or entity other than a factory trained representative or Hamilton Manufacturing Corp. has performed or attempted to perform the subject repair or service.
9. Using equipment which has been serviced or repaired for anything other than its intended or designed use such as downloading software applications not certified by Seller will void the Limited Warranty Agreement. This includes software/applications such as e-mail, spyware, screen savers, viruses, worms, third party software, web search engines, cookies, spam, desktop applications, games, web surfing, etc.

THIS AGREEMENT IS MADE WITH THE EXPRESS UNDERSTANDING THAT THERE ARE NO IMPLIED WARRANTIES THAT THE EQUIPMENT SHALL BE MERCHANTABLE, OR THAT THE GOODS SHALL BE FIT FOR ANY PARTICULAR PURPOSE. PURCHASER HEREBY ACKNOWLEDGES THAT IT IS NOT RELYING ON THE SELLER'S SKILL OR JUDGMENT TO SELECT OR FURNISH EQUIPMENT SUITABLE FOR ANY PARTICULAR PURPOSE AND THAT THERE ARE NO WARRANTIES WHICH EXTEND BEYOND THAT WHICH IS DESCRIBED HEREIN.

The Purchaser agrees that in no event will the Seller be liable for direct, indirect, or consequential damages or for injury resulting from any defective or non-conforming new, repaired or serviced equipment, or for any loss, damage or expense of any kind, including loss of profits, business interruption, loss of business information or other pecuniary loss arising in connection with this Limited Warranty Agreement, or with the use of, or inability to use the subject equipment regardless of Sellers knowledge of the possibility of the same.



Hamilton Manufacturing Corp.  
1026 Hamilton Drive, Holland, OH 43528  
[www.hamiltonmfg.com](http://www.hamiltonmfg.com)

**SALES**

P: (888) 723-4858  
F: (419) 867-4850  
E: [sales@hamiltonmfg.com](mailto:sales@hamiltonmfg.com)

**CUSTOMER SERVICE**

P: (419) 867-4852  
F: (419) 867-4857  
E: [customerservice@hamiltonmfg.com](mailto:customerservice@hamiltonmfg.com)

**PARTS**

P: (419) 867-4852  
F: (419) 867-4867  
E: [parts@hamiltonmfg.com](mailto:parts@hamiltonmfg.com)